



## Standard spring-diaphragm pressure gauges for differential pressure - overload protected



### Benefits

- Direct indication of the differential pressure
- High overload protection
- Zero correction
- With integrated pressure damping

### Application

For differential pressure measurement at low differential pressure and high static pressure. For non-corrosive gaseous and liquid media which are not highly viscous. Particularly suitable for monitoring filters, pumps and pipe systems.

### Technical specifications

#### Type

MF100Dif D401

#### Nominal size

100

#### Function

The pressures act on two pressure chambers separated by an elastic diaphragm. If there are different pressures in the chambers, the diaphragm is axially displaced against a compression spring. This is transmitted to the movement by means of a rod. The differential pressure is directly indicated by a pointer. The diaphragm is held by a metallic support which results in an overpressure safety of up to 25 bar at both sides.

#### Accuracy class (EN 837-3/6)

2,5

#### Ranges

See ordering table

#### Maximum static pressure

25 bar

#### Overpressure safety

Up to the maximum static pressure at both ends

#### Operating temperature range

Medium: Max. 60 °C

Ambient: -20/+60 °C

#### Temperature performance

Indication error when the temperature of the measuring system deviates from the normal temperature of 20 °C:

at rising temperature approx.  $\pm 0.5 \text{ \%}/10 \text{ K}$

falling temperature approx.  $\pm 0.5 \text{ \%}/10 \text{ K}$

of full scale value

#### Degree of protection

IP 54 (EN 60529)

Standard version

<b>Connection</b>	<b>Pointer</b>
Brass nickel-plated, bottom, parallel, one behind the other	Aluminium, black
<b>Measuring element</b>	<b>Housing</b>
Compression spring, Stainless steel 301	Stainless steel 304
<b>Diaphragm</b>	<b>Bayonet type bezel</b>
FKM (Viton)	Stainless steel 304
<b>Measuring flange</b>	<b>Window</b>
Aluminium, anodized	Laminated safety glass
<b>Movement</b>	
Brass	
<b>Dial</b>	
Aluminium, white	
Scaling black	

Options

- Glycerine filling (type D 8)
- Back flange
- Special scales
- Other process connections

Technical drawings

Bottom connection

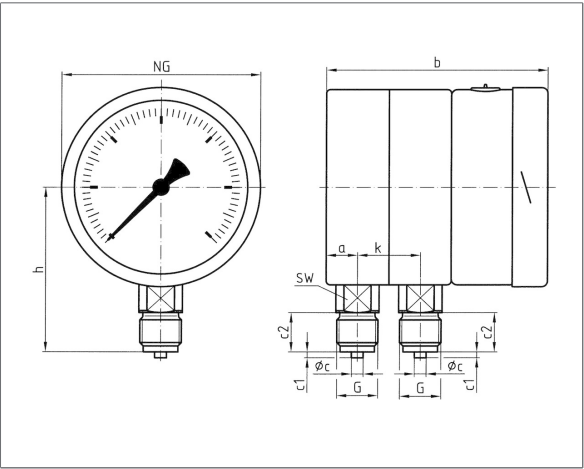

Dimensions (mm)

NG	a	b	Øc	c1	c2	G	h	k	SW
100	16	112,5	6	3	20	G½B	84	32	22

Versions

MF100Dif D401

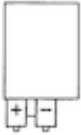

Housing ∅	Housing	Accuracy class	Connection	Range	Type	Part no.
100 mm	Stainless steel 304	2,5	2 x G½B	0/250 mbar	MF100Dif D401	88086401
100 mm	Stainless steel 304	2,5	2 x G½B	0/400 mbar	MF100Dif D401	88087401
100 mm	Stainless steel 304	2,5	2 x G½B	0/600 mbar	MF100Dif D401	88088401
100 mm	Stainless steel 304	2,5	2 x G½B	0/1 bar	MF100Dif D401	88089401
100 mm	Stainless steel 304	2,5	2 x G½B	0/1.6 bar	MF100Dif D401	88090401
100 mm	Stainless steel 304	2,5	2 x G½B	0/2.5 bar	MF100Dif D401	88091401
100 mm	Stainless steel 304	2,5	2 x G½B	0/4 bar	MF100Dif D401	88092401
100 mm	Stainless steel 304	2,5	2 x G½B	0/6 bar	MF100Dif D401	88093401

Blue part no. = in-stock items