



Standard capsule pressure gauges for differential pressure type D9



Benefits

- Measurement of extremely small differential pressures
- Robust design
- Static pressures up to 400 mbar
- Direct indication of the differential pressure
- Many customised versions available

Application

For differential pressure measurement of non-corrosive, gaseous, dry media. Especially suitable for filter loss measurement in air conditioning and ventilation applications.

! For measuring gas or vapour, observe the table "Selection Criteria as per EN 837-2" (see appendix)!

Technical specifications

Type
D9

Nominal size
63

Function
The "plus" pressure (= high pressure) is applied to the inside of the diaphragm. The "minus" pressure (= low pressure) is applied to the inside of the pressure-tight housing. The pressure difference causes the diaphragm to change its shape, thus generating the movement required to measure the pressure. This displacement is picked up by the movement. The differential pressure is directly indicated by a pointer.

Accuracy class (EN 837-3/6)
4,0
1,6

Ranges (EN 837-3/5)
See ordering table

Application area
Static load: Full scale value
Dynamic load: 0.9 x full scale value

Overpressure safety
Full scale value

Maximum static pressure
400 mbar

Operating temperature range
Medium: Max. 60 °C
Ambient: -20/+60 °C

Temperature performance
Indication error when the temperature of the measuring system deviates from the normal temperature of 20 °C:
at rising temperature approx. ± 0.6 %/10 K
falling temperature approx. ± 0.6 %/10 K
of full scale value

Degree of protection
IP 66 (EN 60529)

Standard version

- Connection**
Brass, centre back, parallel, below each other

Measuring element (wetted part)
Capsule element, CuBe alloy

Movement (wetted part)
Brass

Zero correction
From the front

Seal (wetted part)
NBR (Perbunan)

Dial (wetted part)
Aluminium, black
Scaling black
- Pointer (wetted part)**
Aluminium, black

Housing (wetted part)
Stainless steel 304

Bayonet type bezel
Stainless steel 304

Window (wetted part)
Plastic (PMMA)

Options

- Back flange
- 3-hole fixing, panel mounting bezel
- Hose connections
- Special scales
- Other process connections

Technical drawings

NG 63 – centre back connection

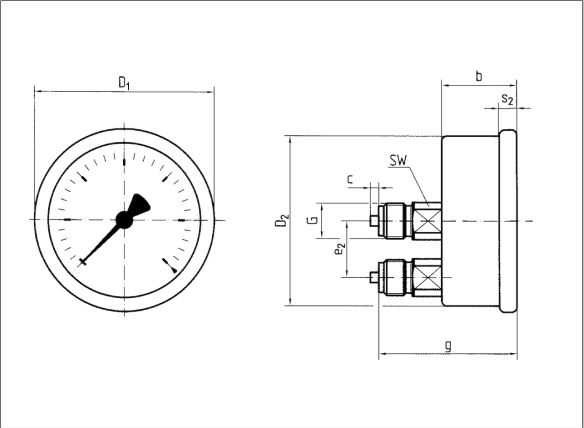

Dimensions (mm)

NG	b	c	D1	D2	e2	g	G	s2	SW
63	30,5	2	68	62	20	53	G¾B	6	14



Versions

KP63Dif D911

Housing 	Housing	Accuracy class	Connection	Range	Type	Part no.
63 mm	Stainless steel 304	4,0	2 x G $\frac{1}{4}$ B	0/16 mbar	KP63Dif D911	35515911
63 mm	Stainless steel 304	1,6	2 x G $\frac{1}{4}$ B	0/25 mbar	KP63Dif D911	35516911
63 mm	Stainless steel 304	1,6	2 x G $\frac{1}{4}$ B	0/40 mbar	KP63Dif D911	35517911
63 mm	Stainless steel 304	1,6	2 x G $\frac{1}{4}$ B	0/60 mbar	KP63Dif D911	35518911
63 mm	Stainless steel 304	1,6	2 x G $\frac{1}{4}$ B	0/100 mbar	KP63Dif D911	35519911
63 mm	Stainless steel 304	1,6	2 x G $\frac{1}{4}$ B	0/160 mbar	KP63Dif D911	35520911
63 mm	Stainless steel 304	1,6	2 x G $\frac{1}{4}$ B	0/250 mbar	KP63Dif D911	35521911
63 mm	Stainless steel 304	1,6	2 x G $\frac{1}{4}$ B	0/400 mbar	KP63Dif D911	35522911

Blue part no. = in-stock items